



# **SANITARY SEWER OVERHEAD ASSISTANCE PROGRAM S.O.A.P.**

Reimbursement program with a 65% maximum, up to \$5,000.

**THIS FULL PACKET SHOULD ONLY BE COMPLETED FOR  
THOSE RESIDENTS WHO RESIDE IN THE  
UNINCORPORATED PORTIONS OF FOX METRO'S  
SERVICE AREA**

For those residents within the municipal limits of the City of Aurora or the Villages of North Aurora, Sugar Grove, or Oswego please contact them for application procedures. Upon successful approval and completion of the municipality's program, Fox Metro W.R.D. will reimburse up to an additional 15% of approved cost (\$5,000 max.). Most municipalities offer a 50% cost share program. Prior to Fox Metro's payment of the approved reimbursement amount, we will require verification that the interior work has passed all required municipal inspections. In addition, a detailed estimate of work performed, as well as proof that the bill has been paid (both sides of a cancelled check or a credit card receipt) will also be required. For residents in incorporated areas, please complete only the "Request for Reimbursement" form and then submit to Fox Metro's Engineering Department.

# S.O.A.P. Frequently Asked Questions (FAQ)

## 1. What is Fox Metro's S.O.A.P.?

Fox Metro WRD's Sanitary Sewer Overhead Assistance Program (S.O.A.P.) was established to provide financial assistance to homeowners who desire to protect their home from sanitary sewer backup during a heavy rain event. Eligible homeowners may qualify for a 65% cost sharing, up to a maximum of \$5,000.00 for installing an overhead sewer system which can protect their basements from sewer back-up. Some "modified" overhead sewer designs may also qualify.

## 2. How does the Overhead Sewer work?

Typically, homes which have experienced sewer back-ups in basements resulting from surcharged sanitary sewer systems during a heavy rain event have a gravity type sewer (see sketch "A" on page 4). Typically, the sanitary sewer in residences with basements flows underneath the basement floor, then drains to the sewer in the street by gravity. When the sanitary sewers become overloaded, the gravity type sewer under the basement floor is subject to back-up.

Changing the basement plumbing to an Overhead Sewer (see sketch B on page 5) can protect the basement from back-ups. Basically, the plumbing in the basement gets re-plumbed and then directed to a sewage ejector pit. The ejector pump lifts the sewage up "overhead" within the basement to join with other sewage from upper floors, then flows gravity down to about mid-height of the basement wall where it exits the foundation wall to the outside of the building, then to the exterior where there is a diagonal section of pipe where it continues to the lateral line and then to Fox Metro's sanitary sewer. If the sanitary sewer backs-up, the homeowner is protected, as the sewage will stay inside of the internal and external sewer piping, and not into the house/basement.

## 3. What is required for reimbursement in the S.O.A.P.?

The homeowner must fill out the S.O.A.P. Eligibility Evaluation Form and then submit it to Fox Metro's Engineering Department for approval.

In order to qualify for this program, the proposed overhead sewer remedy must accomplish several things:

- a. If a proper sump pit for a perimeter/footing drain tile already exists, this requirement is not applicable. However, if the footing drain tile discharges to the sanitary service, said drain tile and any other source of storm water must be disconnected from the sanitary sewer. Installation of a sump pit and pump **are required at this time**. The sump pump is to discharge the storm water onto the ground (grass area is best), or directly to the nearest storm sewer.
- b. All additional storm sewer work is proposed such as connecting a rear-yard drain or downspouts to the storm system, all work shall be in accordance with the specifications of the governing municipality (Township, County, City, Village etc.).
- c. An overhead sewer, as previously described, needs to be installed per Sketch B, on page 5. The selected contractor needs to provide a detailed sketch on the applicable Fox Metro permit form which communicates all of the work to be performed. A corresponding and fully itemized

estimate for all proposed work is required to be submitted to Fox Metro's Engineering Department for review prior to approval.

d. Install at least one full-sized "clean-out" 5' from the foundation of the home.

If acceptable, and approved by Fox Metro, the homeowner must then obtain three (3) ITEMIZED cost estimates from three (3) licensed and bonded contractors.

PRIOR to commencement of work, the homeowner must fill out the Fox Metro S.O.A.P. Permit & Homeowner Participation Agreement forms.

#### **4. Which costs are eligible?**

There are certain costs which are eligible for Fox Metro's S.O.A.P. and others that are not.

##### **Eligible costs are as follows, but not limited to:**

- Cost of location, excavation and exposure of the house lateral sewer line for re-connection of a new overhead sewer to the existing lateral.
- Cost of a new sanitary ejector pump & pit and/or sump pump & pit and associated electrical and plumbing work needed to lift sanitary drainage from the basement plumbing fixtures to an overhead sewer.
- Cost of interior trenching and concrete floor repairs.
- Cost of grass seeding to restore disrupted grass/lawns.
- Battery backup system for the new sump pump.
- Applicable permit fees.

##### **Non-Eligible Costs, but not limited to:**

- Removal and Replacement of interior walls and existing finishes.
- Use of materials not meeting the requirements of Fox Metro W.R.D.'s general plumbing notes (see page 6) or Fox Metro's Sewer Use Ordinance (S.U.O.).
- Ancillary homeowner improvements not necessary to provide sanitary sewer back-up protection of the basement.
- Planting or replacement of new landscaping (bushes, trees, sod, fences, walls, etc.)
- New electrical panels and/or upgrading the house electrical supply.

#### **5. Must I use the lowest priced contractor?**

No, but the work must be completed in accordance with the information contained herein and Fox Metro's applicable codes and ordinances. The reimbursement maximum is 65% up to \$5,000.

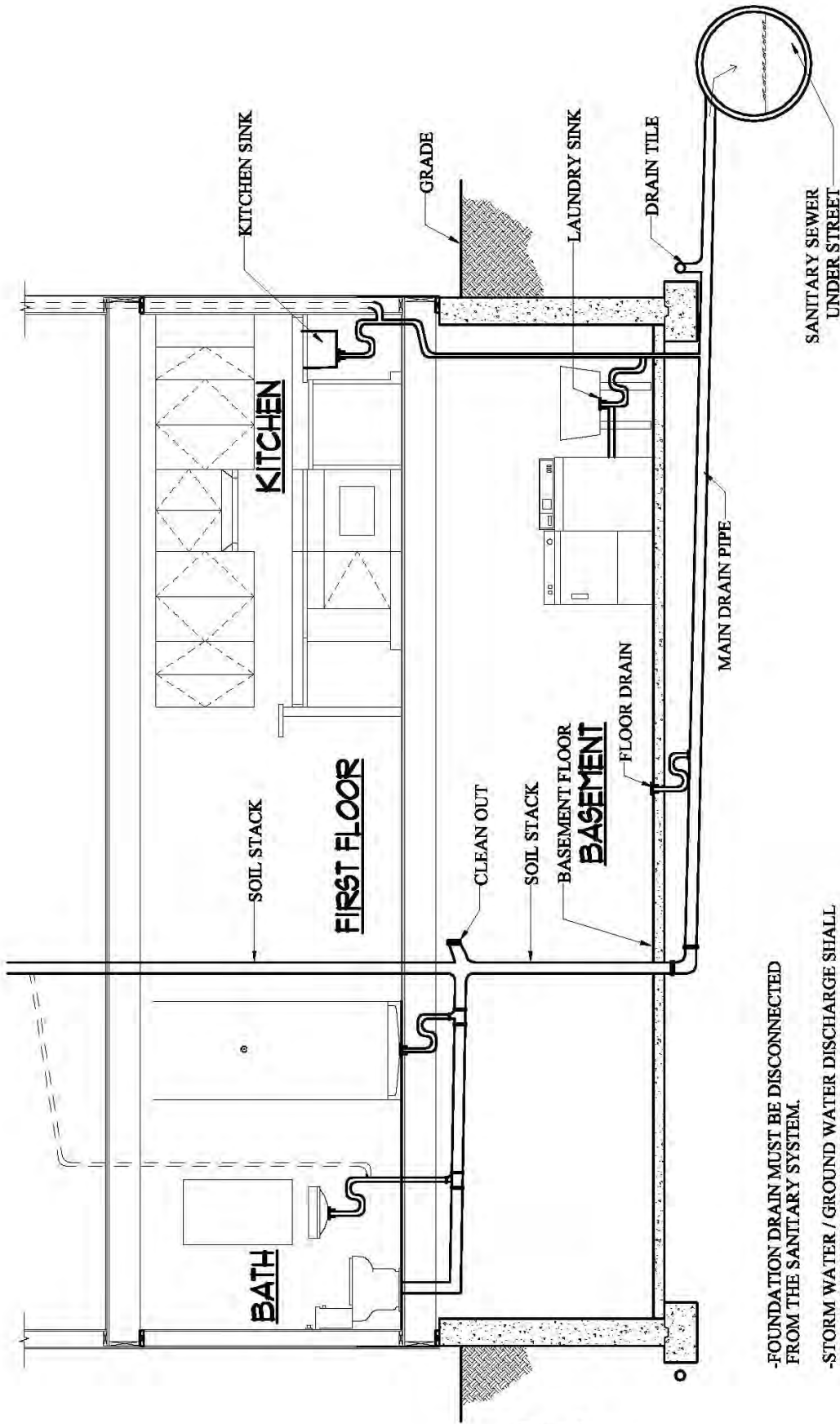

-FOUNDATION DRAIN MUST BE DISCONNECTED FROM THE SANITARY SYSTEM.

-STORM WATER / GROUND WATER DISCHARGE SHALL BE DISPOSED OF PROPERLY.

-IN SOME HOMES, THE BASEMENT WASH TUB, FLOOR DRAINS AND KITCHEN PLUMBING MAY DISCHARGE TO AN EXTERIOR CATCH BASIN LOCATED BEHIND OR ALONG SIDE THE BUILDING

- SOME HOME MAY ALSO HAVE A FOUNDATION DRAIN WITH A GRAVITY CONNECTION TO A SUMP PUMP IN THE BASEMENT

# BEFORE

**SKETCH A : EXAMPLE OF A TYPICAL GRAVITY DRAINAGE SYSTEM**

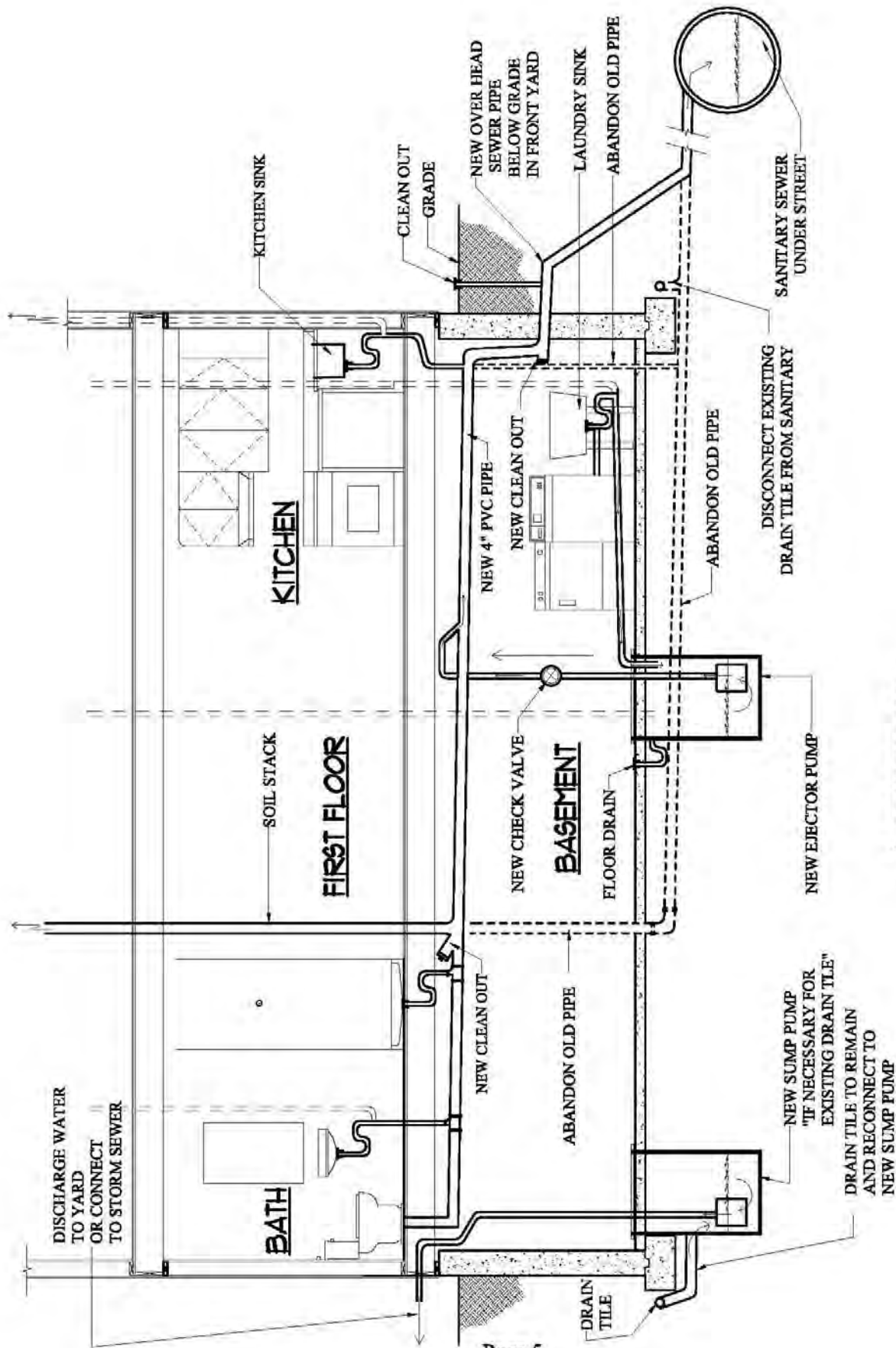

# AFTER

**SKETCH B : EXAMPLE OF A CONVERSION TO AN OVERHEAD SEWER SYSTEM**

## GENERAL PLUMBING NOTES

1. In order to qualify for Fox Metro's S.O.A.P., it shall be agreed that the perimeter drain tile (footing drain), storm water, or any other non-sanitary flows must be disconnected from the sanitary sewer. Installation of a sump pump and pit is required to discharge the storm water onto the ground or to the storm sewer in the street.
2. If there is less than a 10'-0" horizontal separation of the water service to any sanitary sewer line, ASTM D-2241 sewer pipe is required.
3. Where manufactured pipe joints cannot be utilized, or where dissimilar materials are joined, "non-shear" type couplings shall be used for all such connections.
4. Provide a full-sized cleanout just outside of the building (6" cleanout for existing 6" services, 4" cleanout for existing 4" services etc.).
5. The Contractor shall restore all interior and exterior surfaces disturbed due to excavation in-kind.
6. The application shall include a detailed description and sketch of the exterior extent of work.
7. A sewage ejector pump shall discharge only flows from fixtures located in the basement UP to the newly installed overhead piping in said basement.